

The Muslim West | Defence

Citadels: the final urban stronghold.

Along with the outer walls, a town's citadel formed part of its defensive system. The fortified enclosure was located within the town, usually at its highest part and could accommodate and protect either the ruling classes, if the threat came from within the town itself, or the urban population, if the threat was external. The citadel was used by the ruling classes as a stronghold from which to put down rebellions, prepare campaigns and defend their borders.



Name:

Citadel

Dynasty:

Hegira 4th–10th centuries / AD 10th–15th centuries Umayyad, Taifa kingdoms, Nasrid, Christian kings

Details:

Almería, Spain

Justification:

This fortified enclosure accommodated the governor and his garrison. It could provide for all of its inhabitants' day-to-day needs, allowing them to resist sieges of considerable duration.

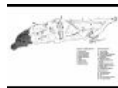

Name:

Citadel

Dynasty:

Hegira 4th–10th centuries / AD 10th–15th centuries Umayyad, Taifa kingdoms, Nasrid, Christian kings

Details:

Almería, Spain

Justification:

This fortified enclosure accommodated the governor and his garrison. It could provide for all of its inhabitants' day-to-day needs, allowing them to resist sieges of considerable duration.



Name:

Citadel

Dynasty:

Hegira 4th–10th centuries / AD 10th–15th centuries Umayyad, Taifa kingdoms, Nasrid, Christian kings

Details:

Almería, Spain

Justification:

This fortified enclosure accommodated the governor and his garrison. It could provide for all of its inhabitants' day-to-day needs, allowing them to resist sieges of considerable duration.



Name:

Málaga Citadel and Gibralfaro Castle

Dynasty:

Hegira 5th–8th centuries / AD 11th–14th centuries Taifa kingdoms of Banu Hammud and Banu Ziri; Nasrid

Details:

Málaga, Spain

Justification:

This fortified enclosure accommodated the governor and his garrison. It could provide for all of its inhabitants' day-to-day needs, allowing them to resist sieges of considerable duration.



Name:

Málaga Citadel and Gibralfaro Castle

Dynasty:

Hegira 5th–8th centuries / AD 11th–14th centuries Taifa kingdoms of Banu Hammud and Banu Ziri; Nasrid

Details:

Málaga, Spain

Justification:

This fortified enclosure accommodated the governor and his garrison. It could provide for all of its inhabitants' day-to-day needs, allowing them to resist sieges of considerable duration.



Name:

Málaga Citadel and Gibralfaro Castle

Dynasty:

Hegira 5th–8th centuries / AD 11th–14th centuries Taifa kingdoms of Banu Hammud and Banu Ziri; Nasrid

Details:

Málaga, Spain

Justification:

This fortified enclosure accommodated the governor and his garrison. It could provide for all of its inhabitants' day-to-day needs, allowing them to resist sieges of considerable duration.



Name:

Chefchaouen Kasbah

Dynasty:

Hegira 10th–11th centuries / AD 15th–16th centuries Wattasid; Sa'did

Details:

Chefchaouen, Morocco

Justification:

This fortified enclosure accommodated the governor and his garrison. It could provide for all of its inhabitants' day-to-day needs, allowing them to resist sieges of considerable duration.



Name:

Chefchaouen Kasbah

Dynasty:

Hegira 10th–11th centuries / AD 15th–16th centuries Wattasid; Sa'did

Details:

Chefchaouen, Morocco

Justification:

This fortified enclosure accommodated the governor and his garrison. It could provide for all of its inhabitants' day-to-day needs, allowing them to resist sieges of considerable duration.

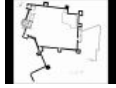
**Name:**

Chefchaouen Kasbah

Dynasty:

Hegira 10th–11th centuries / AD 15th–16th centuries Wattasid; Sa'did

Details:

Chefchaouen, Morocco

Justification:

This fortified enclosure accommodated the governor and his garrison. It could provide for all of its inhabitants' day-to-day needs, allowing them to resist sieges of considerable duration.

**Name:**

Qasr al-Manar (Fortress of the Keep)

Dynasty:

Hegira 397-8 / AD 1007-8 Hammadid

Details:

Qal'at Bani Hammad, Msila, Algeria

Justification:

This fortified enclosure accommodated the governor and his garrison. It could provide for all of its inhabitants' day-to-day needs, allowing them to resist sieges of considerable duration.

**Name:**

Qasr al-Manar (Fortress of the Keep)

Dynasty:

Hegira 397-8 / AD 1007-8 Hammadid

Details:

Qal'at Bani Hammad, Msila, Algeria

Justification:

This fortified enclosure accommodated the governor and his garrison. It could provide for all of its inhabitants' day-to-day needs, allowing them to resist sieges of considerable duration.

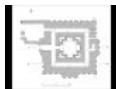
**Name:**

Qasr al-Manar (Fortress of the Keep)

Dynasty:

Hegira 397-8 / AD 1007-8 Hammadid

Details:

Qal'at Bani Hammad, Msila, Algeria

Justification:

This fortified enclosure accommodated the governor and his garrison. It could provide for all of its inhabitants' day-to-day needs, allowing them to resist sieges of considerable duration.
